



Name: Form:

See pages 20 and 21 of *Springs and magnets*

Seeing how a magnet works

Tiny pieces of iron and steel can be used to show where a magnet is working.

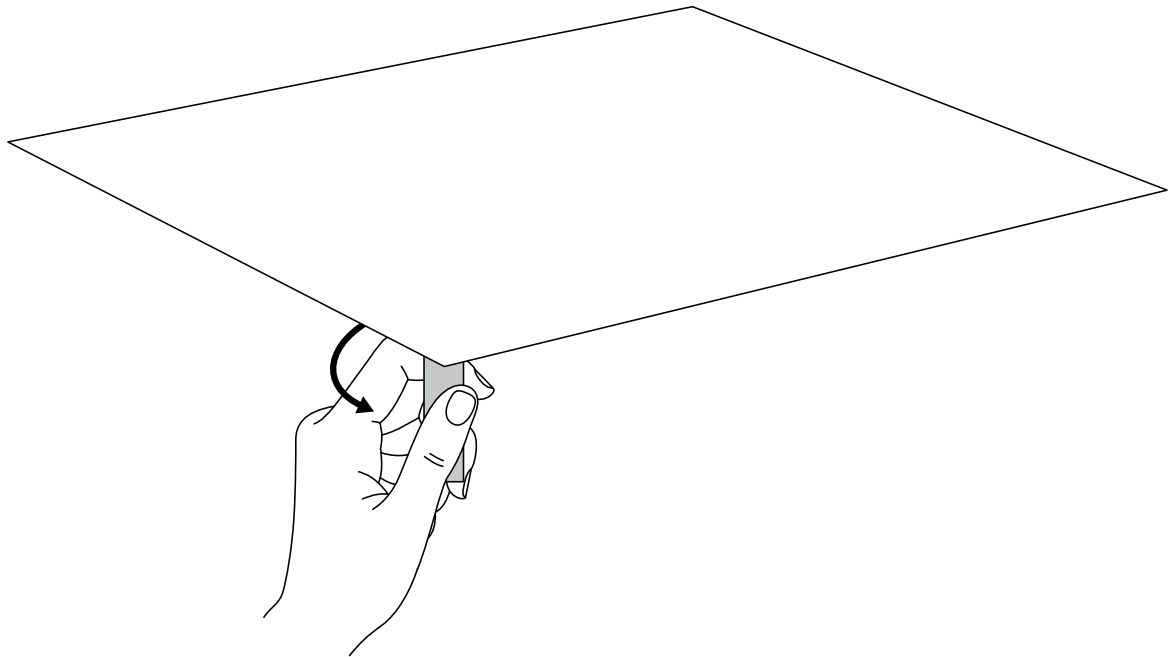

Q1. The picture shows a magnet being moved about under a sheet of cardboard. Draw how tiny pieces of iron that were scattered on the top of the cardboard are affected by the movement of the magnet.

Q2. What are very fine pieces of iron called? 

Q3. When tiny pieces of iron are sprinkled on the cardboard, what happens to some of them?



Q4. What should you do to a corner of the cardboard if you want to make a pattern with the tiny pieces of iron?



Q5. (i) Which are the most powerful parts of the magnet? 

(ii) How can you tell the most powerful parts of the magnet?



